

frandoli

Schede Tecniche

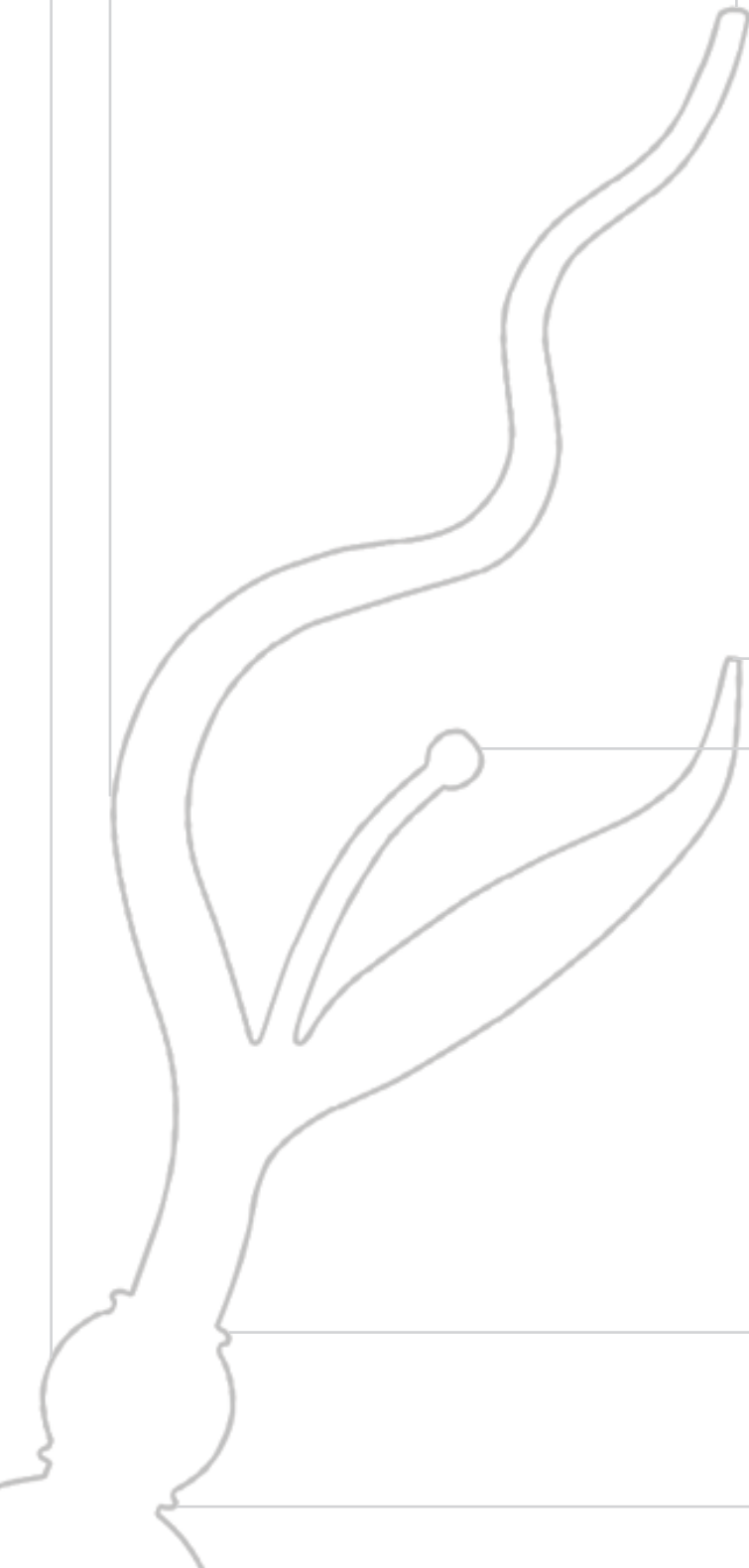

IA140/IA141 CLASSIC

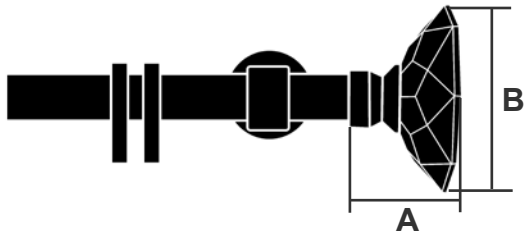

DIAMETRO ASTA / ROD DIAMETER	TERMINALE/FINIAL	
Diametro mm	A mm	B mm
Ø 20	41	70

IA142/IA143 MODERN

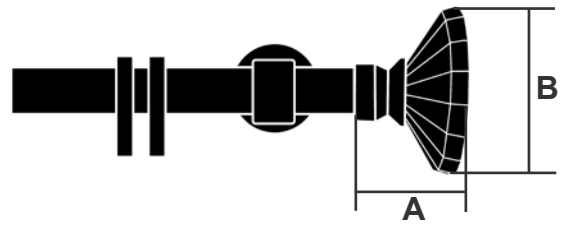

DIAMETRO ASTA / ROD DIAMETER	TERMINALE/FINIAL	
Diametro mm	A mm	B mm
Ø 20	41	70

CLASSIC E MODERN FRONTALI

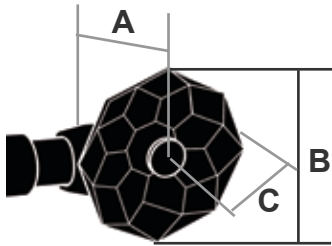

DIAMETRO ASTA / ROD DIAMETER	TERMINALE/FINIAL		
Diametro mm	A mm	B mm	C mm
Ø 20	60	70	35

IA144/IA145 SMALL

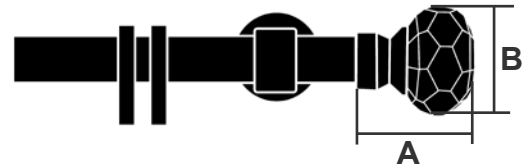

DIAMETRO ASTA / ROD DIAMETER	TERMINALE/FINIAL	
Diametro mm	A mm	B mm
Ø 20	46	41

IA150/IA151 BRILLANTI



DIAMETRO ASTA / ROD DIAMETER	TERMINALE/FINIAL	
Diametro mm	A mm	B mm
Ø 20	51	40
Ø 16	51	40
Ø 14	31	22
Ø 12	31	22

FERMATENDA SUN TIE BACK SUN

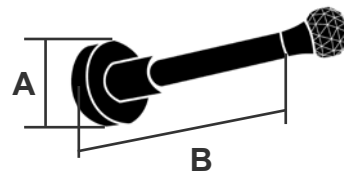

DIAMETRO TUBETTO / TUBE DIAMETER	TERMINALE/FINIAL	
Diametro mm	A mm	B mm
Ø 12	35	50-120

DIAMETRO TUBETTO / TUBE DIAMETER	TERMINALE/FINIAL	
Diametro mm	A mm	B mm
Ø 12	35	50-250

Linea Brillanti ————— FERMATENDA / TIE BACK

FERMATENDA MOON TIE BACK MOON

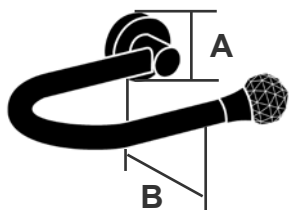

DIAMETRO TUBETTO / TUBE DIAMETER	TERMINALE/FINIAL	
Diametro mm	A mm	B mm
Ø 12	35	94

FERMATENDA MOON E SUN CON TERM. BRILLANTI D.12 OPPURE CON TERM. CLASSIC, MODERN, SMALL
TIE BACK MOON AND SUN WITH FINIAL BRILLANTI D.12 OR WITH CLASSIC, MODERN, SMALL FINIALS

Linea Sky e Brillanti ————— SUPPORTI / BRACKETS

IA250 SKY CHIUSO SKY CLOSED

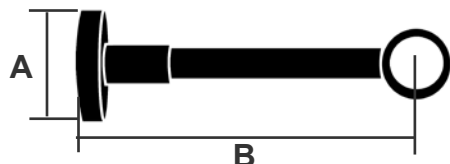

DIAMETRO ASTA ROD DIAMETER	A mm	B mm
Ø 20	45	50-160
Ø 16	45	
Ø 14	35	
Ø 12	35	

DIAMETRO ASTA ROD DIAMETER	A mm	B mm
Ø 20	45	50-250
Ø 16	45	
Ø 14	35	
Ø 12	35	

IA252 SKY CHIUSO DOPPIO SKY DOUBLE CLOSED

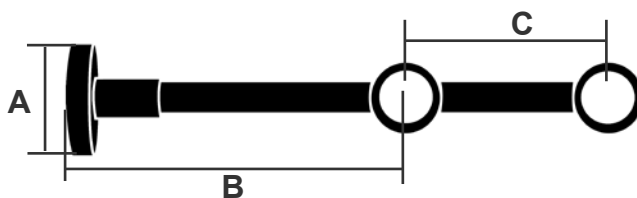

DIAMETRO ASTA ROD DIAMETER	A mm	B mm	C mm
Ø 20	45	50-160	70
Ø 16	45		66
Ø 14	35		64
Ø 12	35		62

DIAMETRO ASTA ROD DIAMETER	A mm	B mm	C mm
Ø 20	45	50-250	70
Ø 16	45		66
Ø 14	35		64
Ø 12	35		62

IA255 SKY APERTO SKY OPENED

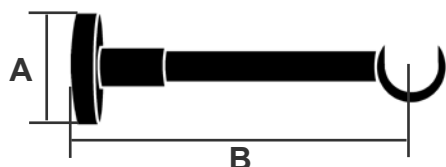

DIAMETRO ASTA ROD DIAMETER	A mm	B mm
Ø 20	45	50-160

DIAMETRO ASTA ROD DIAMETER	A mm	B mm
Ø 20	45	50-250

IA257 SKY APERTO DOPPIO SKY DOUBLE OPENED

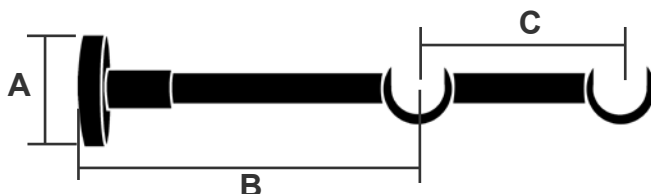

DIAMETRO ASTA ROD DIAMETER	A mm	B mm	C mm
Ø 20	45	50-160	70

DIAMETRO ASTA ROD DIAMETER	A mm	B mm	C mm
Ø 20	45	50-250	70

**IA260 SKY ANGOLARE
SKY CORNER**

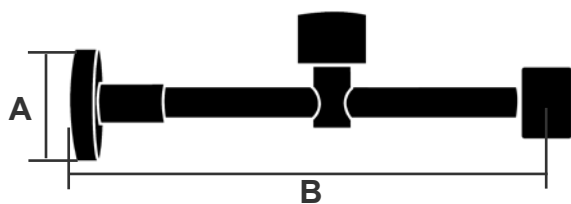

DIAMETRO ASTA ROD DIAMETER	A mm	B mm
Ø 20	45	50-160
Ø 16	45	
Ø 14	35	
Ø 12	35	

DIAMETRO ASTA ROD DIAMETER	A mm	B mm
Ø 20	45	50-250
Ø 16	45	
Ø 14	35	
Ø 12	35	

**IA265 MONOBLOCCO
MONOBLOC**

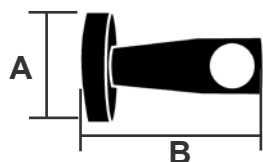

DIAMETRO ASTA ROD DIAMETER	A mm	B mm
Ø 20	45	67
Ø 16	45	55
Ø 14	35	49
Ø 12	35	42

**IA180 ATTACCO A SOFFITTO
CEILING BRACKET**

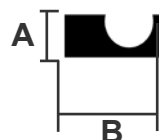

DIAMETRO ASTA ROD DIAMETER	A mm	B mm
Ø 20	24	38
Ø 16	24	34

IA195 MODERN

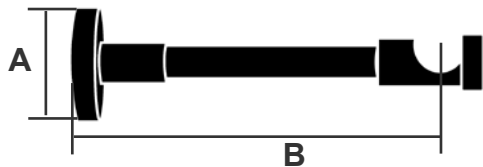

DIAMETRO ASTA ROD DIAMETER	A mm	B mm
Ø 20	45	50-160

DIAMETRO ASTA ROD DIAMETER	A mm	B mm
Ø 20	45	50-250

IA197 MODERN DOPPIO
MODERN-DOUBLE

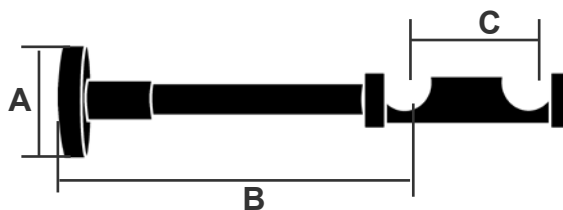

DIAMETRO ASTA ROD DIAMETER	A mm	B mm	C mm
Ø 20	45	50-160	40

DIAMETRO ASTA ROD DIAMETER	A mm	B mm	C mm
Ø 20	45	50-250	40

IA221 TECNO

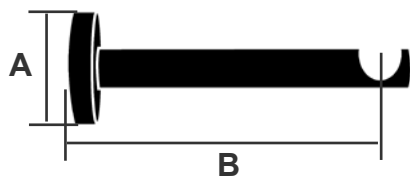

DIAMETRO ASTA ROD DIAMETER	A mm	B mm
Ø 20	45	55
Ø 16	45	
Ø 14	35	
Ø 12	35	

DIAMETRO ASTA ROD DIAMETER	A mm	B mm
Ø 20	45	120
Ø 16	45	
Ø 14	35	
Ø 12	35	

DIAMETRO ASTA ROD DIAMETER	A mm	B mm
Ø 20	45	160
Ø 16	45	
Ø 14	35	
Ø 12	35	

DIAMETRO ASTA ROD DIAMETER	A mm	B mm
Ø 20	45	210
Ø 16	45	
Ø 14	35	
Ø 12	35	

IA223 TECNO DOPPIO
DOUBLE TECNO



DIAMETRO ASTA ROD DIAMETER	A mm	B mm	C mm
Ø 20	45	120	50
Ø 16	45		
Ø 14	35		
Ø 12	35		

DIAMETRO ASTA ROD DIAMETER	A mm	B mm	C mm
Ø 20	45	160	50
Ø 16	45		
Ø 14	35		
Ø 12	35		

DIAMETRO ASTA ROD DIAMETER	A mm	B mm	C mm
Ø 20	45	210	50
Ø 16	45		
Ø 14	35		
Ø 12	35		

**IA266 SKY SOFFITTO
SKY-CEILING**

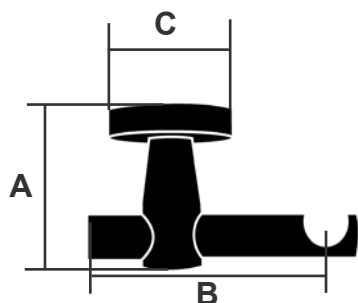

DIAMETRO ASTA ROD DIAMETER	A mm	B mm	C mm
Ø 20	67	60	45
Ø 16	67	60	45

**IA267 SKY SOFFITTO DOPPIO
SKY-CEILING DOUBLE**

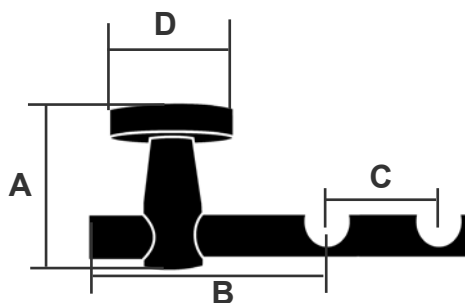

DIAMETRO ASTA ROD DIAMETER	A mm	B mm	C mm	D mm
Ø 20	67	60	50	45
Ø 16	67	60	50	45

**IA270 ROSETTA CHIUSA
CLOSED RECESS BRACKET**

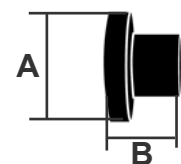

DIAMETRO ASTA ROD DIAMETER	A mm	B mm
Ø 20	35	24
Ø 16	27	18
Ø 14	24	15
Ø 12	20	13

**IA271 ROSETTA APERTA
OPEN RECESS BRACKET**

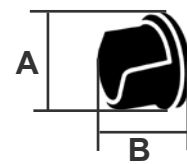

DIAMETRO ASTA ROD DIAMETER	A mm	B mm
Ø 20	35	24
Ø 16	27	18

————— ANELLI / RINGS ———

**IA230-IA231 ANELLO SEZIONE TONDA
ROUND RING**

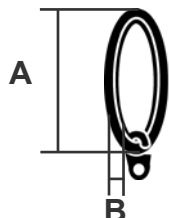

DIAMETRO ASTA ROD DIAMETER	A mm	B mm
Ø 20	48	4
Ø 16	38	4

**IA232-IA233 ANELLO SEZIONE PIATTA
FLAT RING**

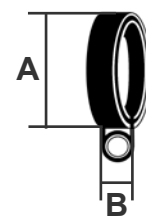

DIAMETRO ASTA ROD DIAMETER	A mm	B mm
Ø 20	40	6
Ø 16	35	5
Ø 14	27	5
Ø 12	27	5