

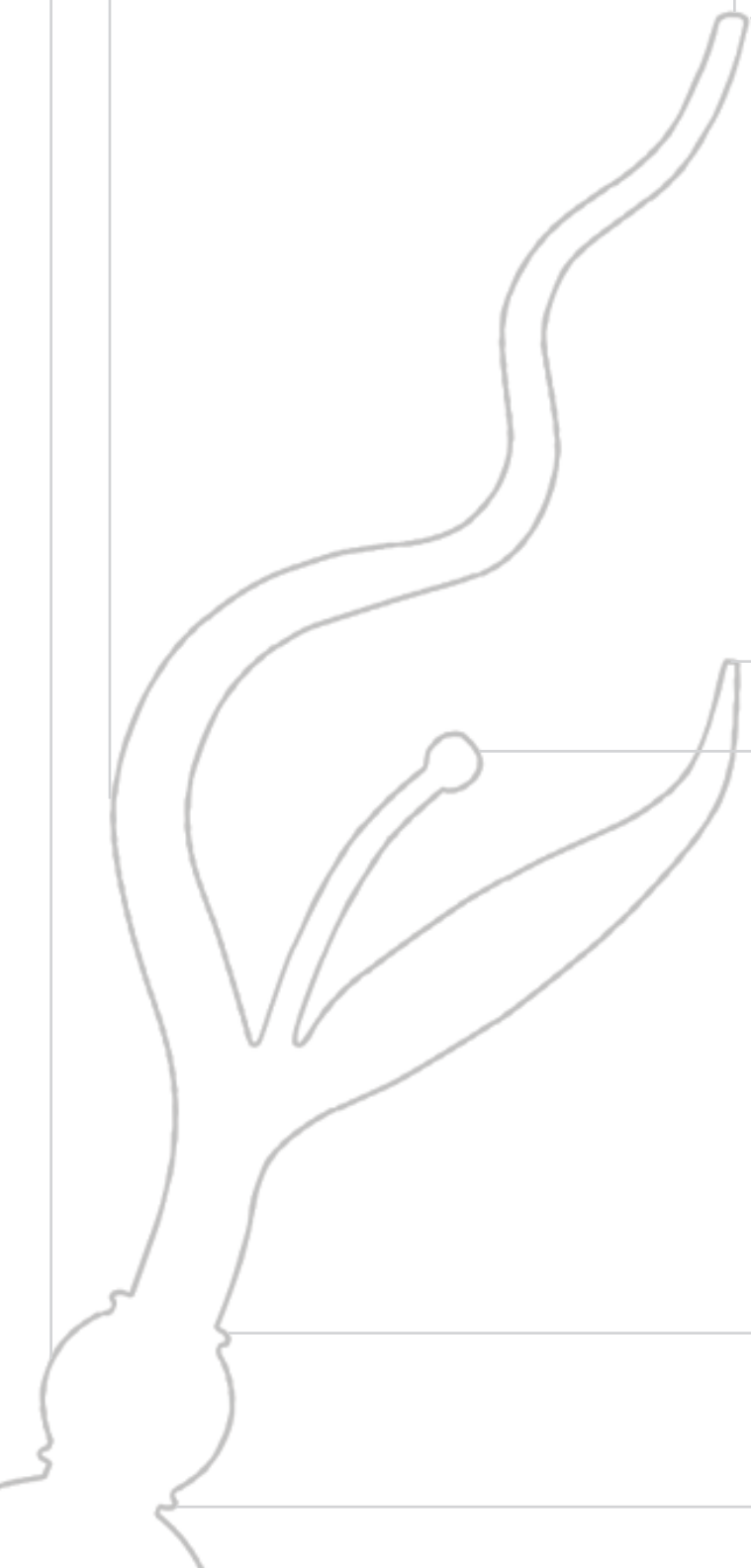

Schede Tecniche



IA105 DIANA



DIAMETRO ASTA / ROD DIAMETER	TERMINALE/FINIAL	
	A mm	B mm
Diametro mm	A	B
Ø 18	58	30

IA107 MINERVA

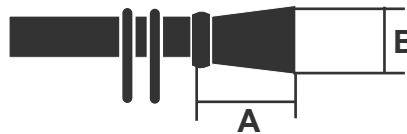

DIAMETRO ASTA / ROD DIAMETER	TERMINALE/FINIAL	
	A mm	B mm
Diametro mm	A	B
Ø 18	42	30

IA106 DAFNE



DIAMETRO ASTA / ROD DIAMETER	TERMINALE/FINIAL	
	A mm	B mm
Diametro mm	A	B
Ø 18	42	24

IA108 OSIRIDE

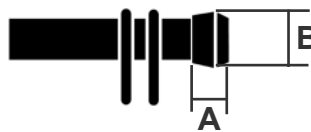

DIAMETRO ASTA / ROD DIAMETER	TERMINALE/FINIAL	
	A mm	B mm
Diametro mm	A	B
Ø 18	16	24

IA170 ECO

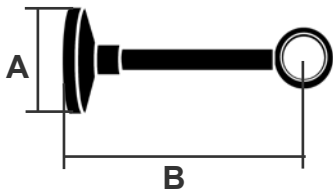

DIAMETRO ASTA ROD DIAMETER	A mm	B mm
Ø 18	45	50-160

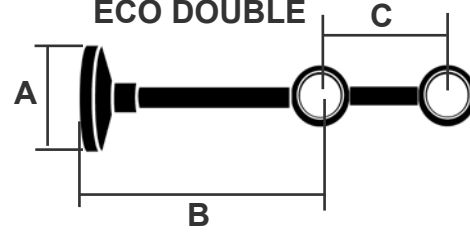
IA172 ECO DOPPIO
ECO DOUBLE

DIAMETRO ASTA ROD DIAMETER	A mm	B mm	C mm
Ø 18	45	50-160	75

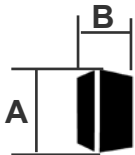
IA174 ROSETTA ECO
ECO RECESS BRACKET

DIAMETRO ASTA ROD DIAMETER	A mm	B mm
Ø 18	25	20

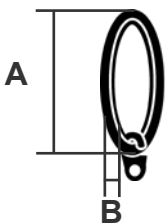
IA230-IA231 ANELLO SEZIONE TONDA
ROUND RING

DIAMETRO ASTA ROD DIAMETER	A mm	B mm
Ø 18	38	4

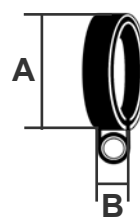
IA233 ANELLO SEZIONE PIATTA
FLAT RING

DIAMETRO ASTA ROD DIAMETER	A mm	B mm
Ø 18	35	5