

Schede Tecniche

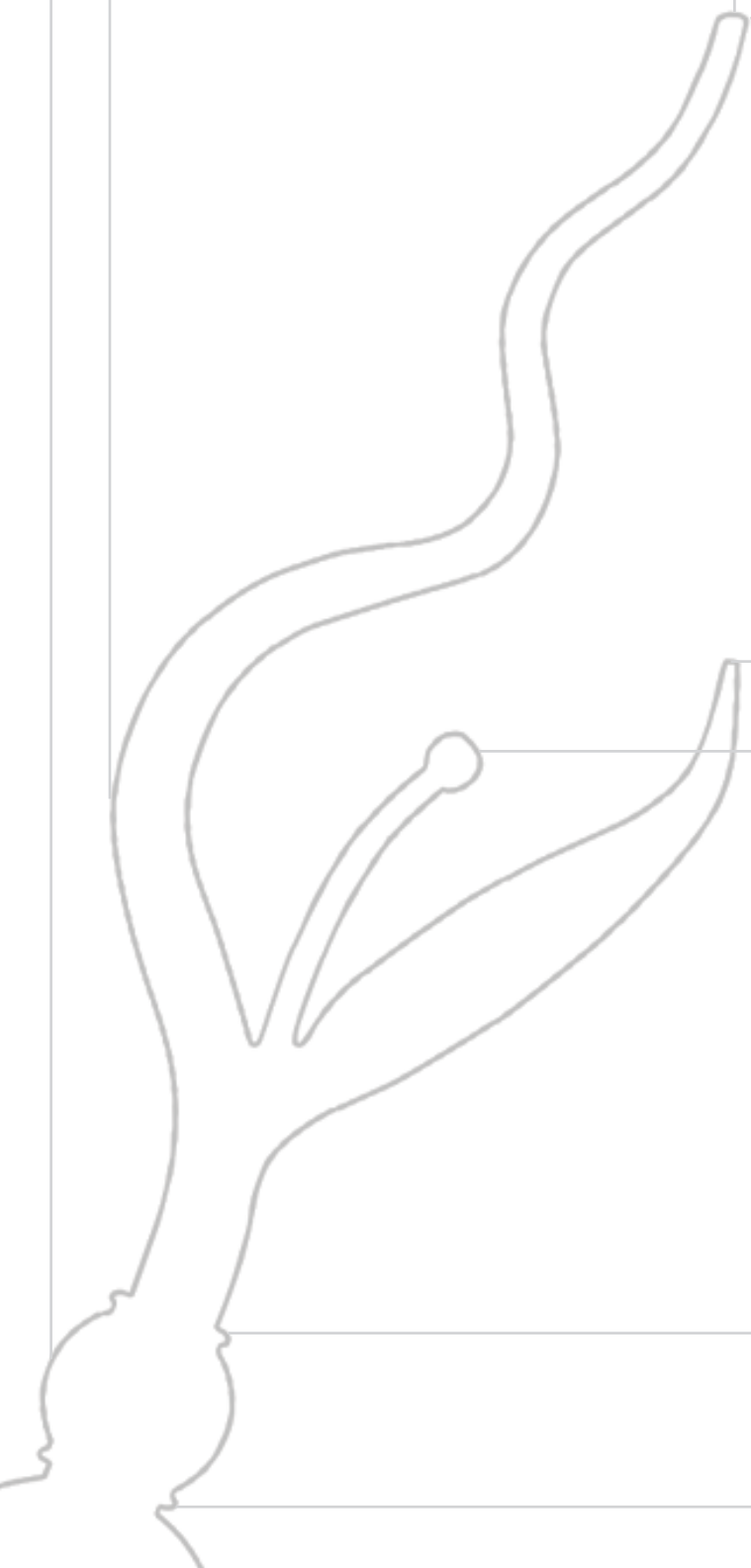

Linea FAMILY _____ TERMINALI / FINIALS

IA091 DENNY IA090 MARTY

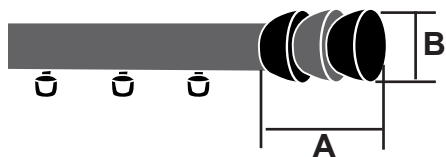

DIAMETRO ASTA / ROD DIAMETER	TERMINALE/FINIAL	
Diametro mm	A mm	B mm
Ø 20	45	30
Ø 16	36	24

IA095 RICKY IA094 LILLY

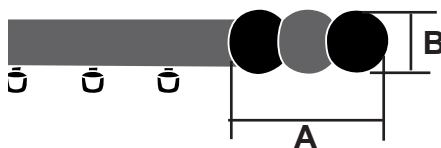

DIAMETRO ASTA / ROD DIAMETER	TERMINALE/FINIAL	
Diametro mm	A mm	B mm
Ø 20	63	26
Ø 16	53	21

IA099 PONGHY IA098 ELE

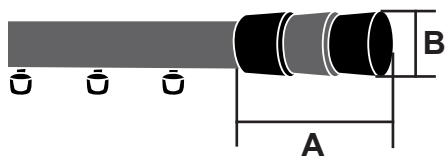

DIAMETRO ASTA / ROD DIAMETER	TERMINALE/FINIAL	
Diametro mm	A mm	B mm
Ø 20	60	27
Ø 16	36	22

IA093 DUKY IA092 LEO

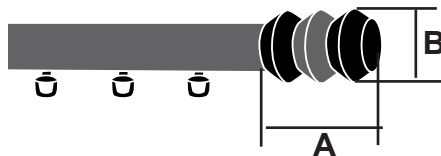

DIAMETRO ASTA / ROD DIAMETER	TERMINALE/FINIAL	
Diametro mm	A mm	B mm
Ø 20	45	30
Ø 16	36	24

IA097 DADO IA096 GOGHY

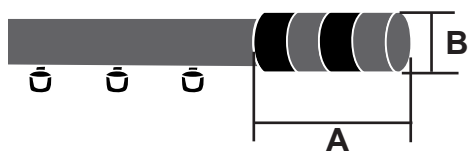

DIAMETRO ASTA / ROD DIAMETER	TERMINALE/FINIAL	
Diametro mm	A mm	B mm
Ø 20	60	25
Ø 16	48	20

IA299-IA298 SUPPORTO MARY-ARY
MARY-ARY BRACKET

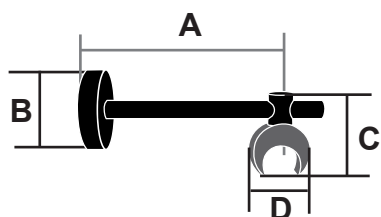

DIAMETRO DIAMETER	A mm	B mm	C mm	D mm
Ø 16	60	45	45	30
Ø 20	60	45	47	32

DIAMETRO DIAMETER	A mm	B mm	C mm	D mm
Ø 16	120	45	45	30
Ø 20	120	45	47	32

DIAMETRO DIAMETER	A mm	B mm	C mm	D mm
Ø 16	180	45	45	30
Ø 20	180	45	47	32

DIAMETRO DIAMETER	A mm	B mm	C mm	D mm
Ø 16	210	45	45	30
Ø 20	210	45	47	32

IA295-IA297 BOCCOLA SOFFITTO MARY-ARY
MARY-ARY CEILING BRACKET

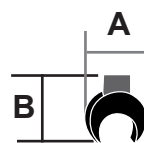

DIAMETRO DIAMETER	A mm	B mm
Ø 16	30	33
Ø 20	32	35

IA250 SKY CHIUSO
SKY CLOSED

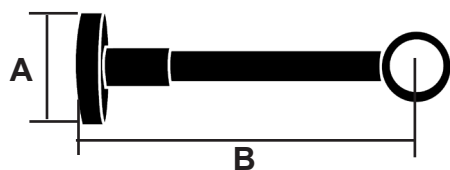

DIAMETRO ASTA ROD DIAMETER	A mm	B mm
Ø 20	45	50-160
Ø 16	45	

DIAMETRO ASTA ROD DIAMETER	A mm	B mm
Ø 20	45	50-250
Ø 16	45	

IA252 SKY CHIUSO DOPPIO
SKY DOUBLE CLOSED

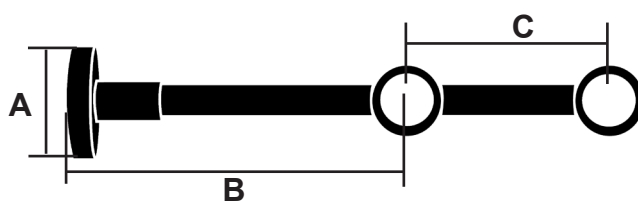

DIAMETRO ASTA ROD DIAMETER	A mm	B mm	C mm
Ø 20	45	50-160	70
Ø 16	45		66

DIAMETRO ASTA ROD DIAMETER	A mm	B mm	C mm
Ø 20	45	50-250	70
Ø 16	45		66

IA255 SKY APERTO
SKY OPENED

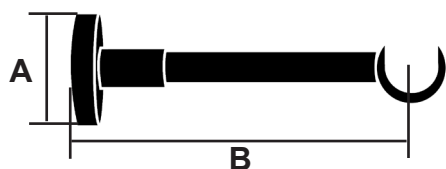

DIAMETRO ASTA ROD DIAMETER	A mm	B mm
Ø 20	45	50-160

DIAMETRO ASTA ROD DIAMETER	A mm	B mm
Ø 20	45	50-250

IA257 SKY APERTO DOPPIO
SKY DOUBLE OPENED

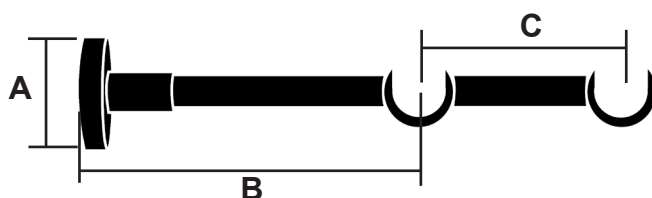

DIAMETRO ASTA ROD DIAMETER	A mm	B mm	C mm
Ø 20	45	50-160	70

DIAMETRO ASTA ROD DIAMETER	A mm	B mm	C mm
Ø 20	45	50-250	70

**IA260 SKY ANGOLARE
SKY CORNER**

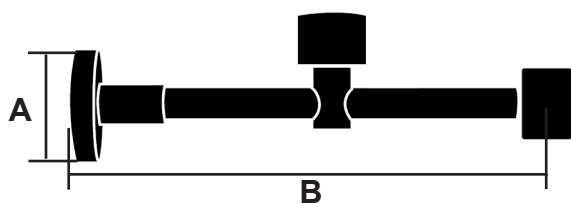

DIAMETRO ASTA ROD DIAMETER	A mm	B mm
Ø 20	45	50-160
Ø 16	45	

DIAMETRO ASTA ROD DIAMETER	A mm	B mm
Ø 20	45	50-250
Ø 16	45	

**IA265 MONOBLOCCO
MONOBLOC**

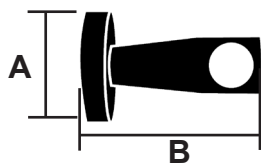

DIAMETRO ASTA ROD DIAMETER	A mm	B mm
Ø 20	45	67
Ø 16	45	55

**IA180 ATTACCO A SOFFITTO
CEILING BRACKET**

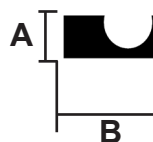

DIAMETRO ASTA ROD DIAMETER	A mm	B mm
Ø 20	24	38
Ø 16	24	34

**IA266 SKY SOFFITTO
SKY-CEILING**

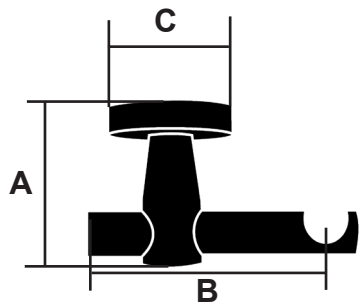

DIAMETRO ASTA ROD DIAMETER	A mm	B mm	C mm
Ø 20	55	120	45
Ø 16	55	120	45

**IA267 SKY SOFFITTO DOPPIO
SKY-CEILING DOUBLE**

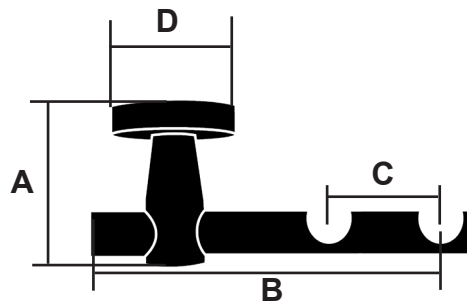

DIAMETRO ASTA ROD DIAMETER	A mm	B mm	C mm	D mm
Ø 20	55	120	50	45
Ø 16	55	120	50	45

**IA221 TECNO
TECNO BRACKET**

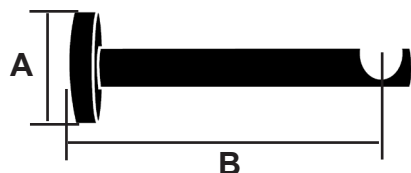

DIAMETRO ASTA ROD DIAMETER	A mm	B mm
Ø 20	45	55
Ø 16	45	

DIAMETRO ASTA ROD DIAMETER	A mm	B mm
Ø 20	45	120
Ø 16	45	

DIAMETRO ASTA ROD DIAMETER	A mm	B mm
Ø 20	45	160
Ø 16	45	

DIAMETRO ASTA ROD DIAMETER	A mm	B mm
Ø 20	45	210
Ø 16	45	

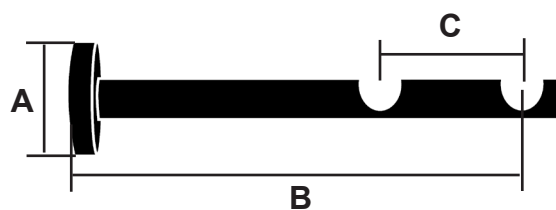
**IA223 TECNO DOPPIO
DOUBLE TECNO**

DIAMETRO ASTA ROD DIAMETER	A mm	B mm	C mm
Ø 20	45	120	50
Ø 16	45		

DIAMETRO ASTA ROD DIAMETER	A mm	B mm	C mm
Ø 20	45	160	50
Ø 16	45		

DIAMETRO ASTA ROD DIAMETER	A mm	B mm	C mm
Ø 20	45	210	50
Ø 16	45		

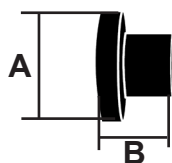
**IA270 ROSETTA CHIUSA
CLOSED RECESS BRACKET**

DIAMETRO ASTA ROD DIAMETER	A mm	B mm
Ø 20	35	24
Ø 16	27	18

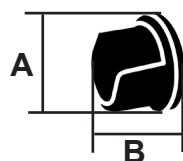
**IA271 ROSETTA APERTA
OPEN RECESS BRACKET**

DIAMETRO ASTA ROD DIAMETER	A mm	B mm
Ø 20	35	24
Ø 16	27	18

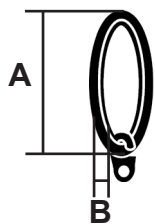
IA230-IA231 ANELLO SEZIONE TONDA
ROUND RING

DIAMETRO ASTA ROD DIAMETER	A mm	B mm
Ø 20	48	4
Ø 16	38	4

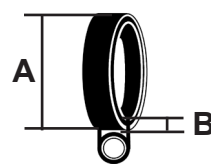
IA232-IA233 ANELLO SEZIONE PIATTA
FLAT RING

DIAMETRO ASTA ROD DIAMETER	A mm	B mm
Ø 20	40	2
Ø 16	35	2

FERMATENDA / CURTAIN STOP

IS091 SUN DENNY

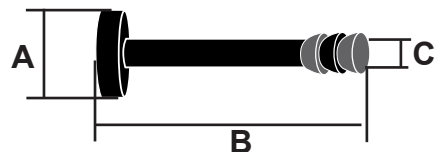

A mm	B mm	C mm
35	50-120	14
A mm	B mm	C mm
35	50-250	14

IM091 MOON DENNY

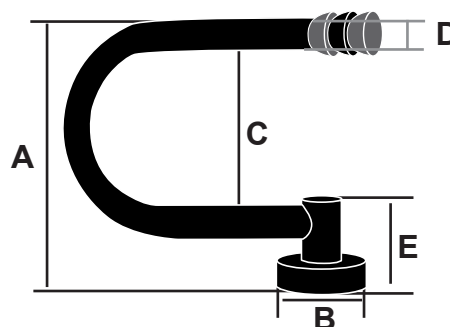

A mm	B mm	C mm	E mm	D mm
94	35	65	55	12

PER I FERMATENDA MOON E SUN VENGONO UTILIZZATI I FINALI FAMILY DA D.12
CURTAIN STOP MOON AND SUN ARE MADE WITH FAMILY FINIALS D.12

IA182 FIOCCO

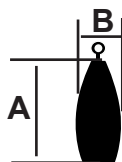

DIAMETRO ASTA ROD DIAMETER	A mm	B mm
Ø 18	43	20