

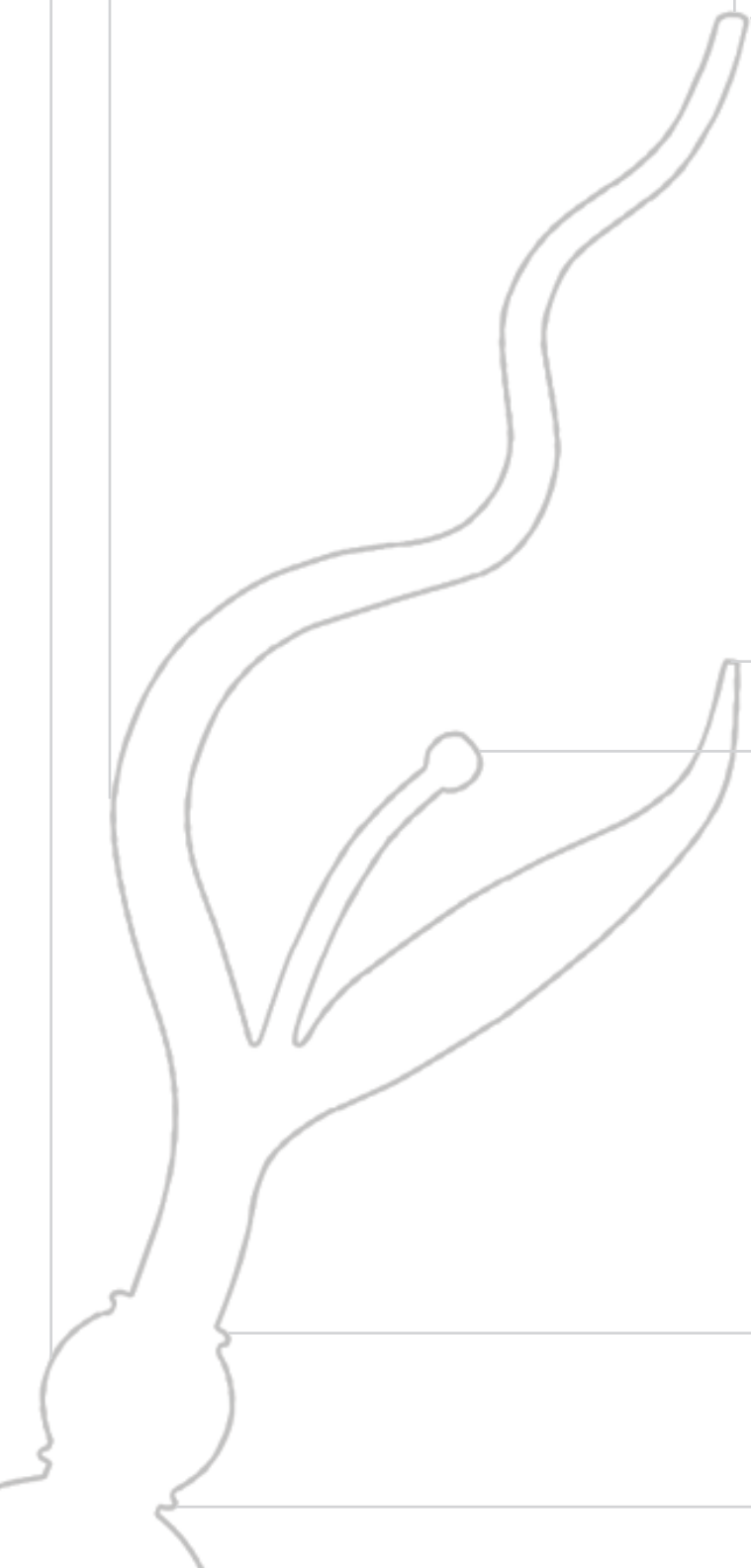

Schede Tecniche

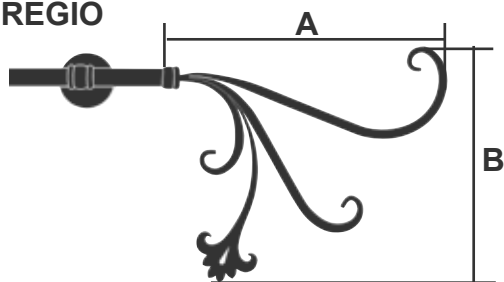

FA148 FREGIO



DIAMETRO ASTA ROD DIAMETER	A mm	B mm
Ø 28	480	500

FA143 DIVA

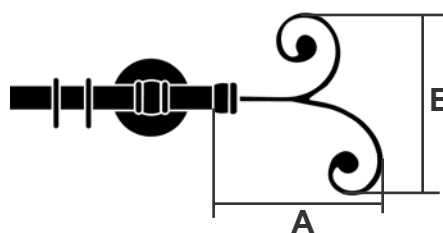

DIAMETRO ASTA ROD DIAMETER	A mm	B mm
Ø 28	200	210

FA145 DORA

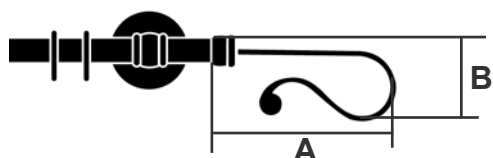

DIAMETRO ASTA ROD DIAMETER	A mm	B mm
Ø 28	200	90

FA144 GRAZIA

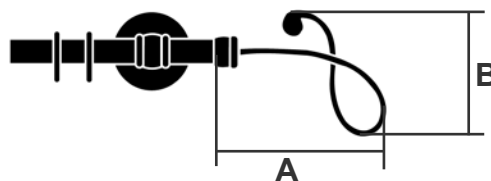

DIAMETRO ASTA ROD DIAMETER	A mm	B mm
Ø 28	205	140

FA146 GEA

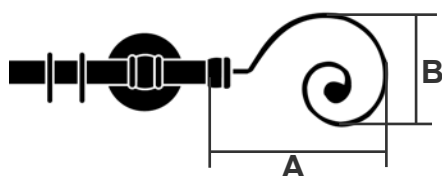

DIAMETRO ASTA ROD DIAMETER	A mm	B mm
Ø 28	210	130

FA142 AIDA

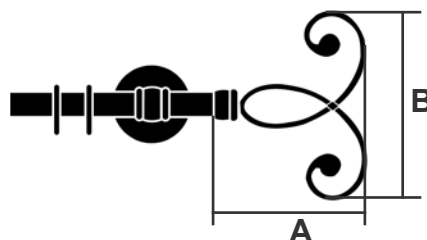

DIAMETRO ASTA ROD DIAMETER	A mm	B mm
Ø 28	170	210

FA147 MILA

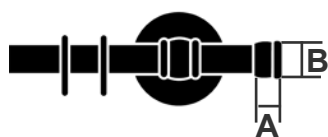

DIAMETRO ASTA ROD DIAMETER	A mm	B mm
Ø 28	25	37

————— SUPPORTI / BRACKETS ———

FA261 SUPPORTO MERLETTI CHIUSO
MERLETTI BRACKET-CLOSED

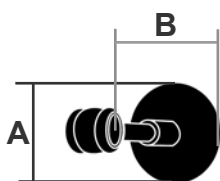

DIAMETRO ASTA ROD DIAMETER	A mm	B mm
Ø 28	100	80-160

DIAMETRO ASTA ROD DIAMETER	A mm	B mm
Ø 28	100	80-240

FA265 SUPPORTO MERLETTI CHIUSO DOPPIO
MERLETTI BRACKET-DOUBLE CLOSED

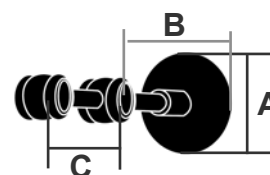

DIAMETRO ASTA ROD DIAMETER	A mm	B mm	C mm
Ø 28	100	80-160	85

DIAMETRO ASTA ROD DIAMETER	A mm	B mm	C mm
Ø 28	100	80-240	85

FA262 SUPPORTO MERLETTI APERTO
MERLETTI BRACKET-OPENED

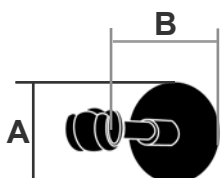

DIAMETRO ASTA ROD DIAMETER	A mm	B mm
Ø 28	100	80-160

DIAMETRO ASTA ROD DIAMETER	A mm	B mm
Ø 28	100	80-240

FA266 SUPPORTO MERLETTI APERTO DOPPIO
MERLETTI BRACKET-DOUBLE OPENED

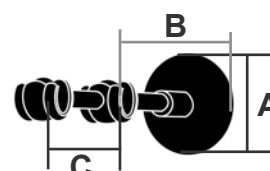

DIAMETRO ASTA ROD DIAMETER	A mm	B mm	C mm
Ø 28	100	80-160	85

DIAMETRO ASTA ROD DIAMETER	A mm	B mm	C mm
Ø 28	100	80-240	85

FA274 ROSETTA CHIUSA
CLOSED RECESS BRACKET

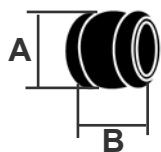

A mm	B mm
37	27

— ANELLI / RINGS —

FA23028 ANELLO SEZIONE TONDA
ROUND RING

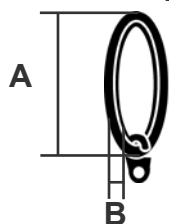

DIAMETRO ASTA ROD DIAMETER	A mm	B mm
Ø 28	55	5

— FERMATENDA / TIE BACK —

FA307 FREGIO



A mm	B mm	C mm
110	80	40

FA306 RODI

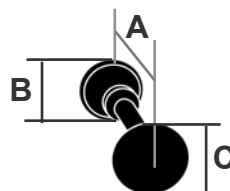

A mm	B mm	C mm
100	25	55
150		
200		