

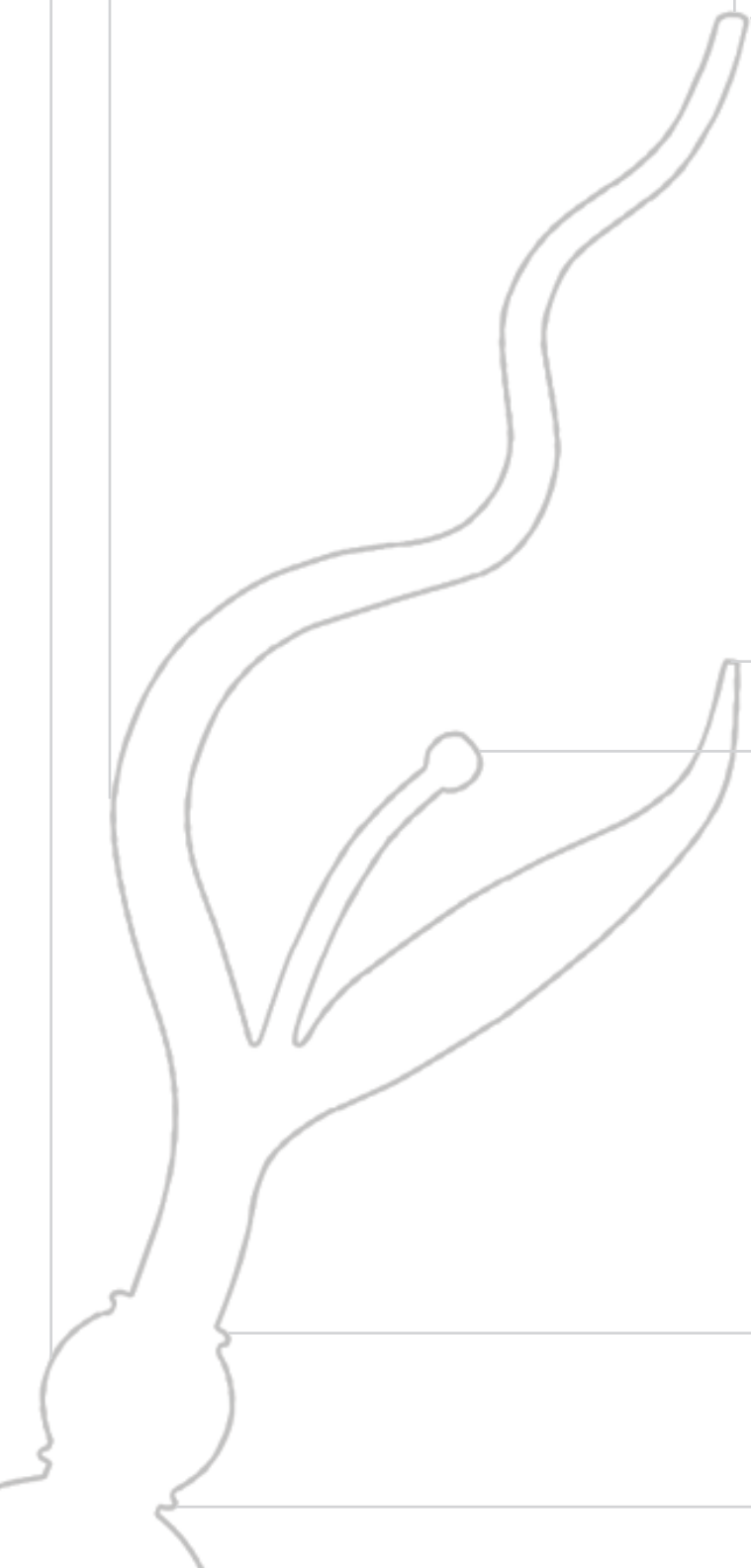

Schede Tecniche



# Linea Sky ————— TERMINALI / FINIALS

## IA130 SOPHY



DIAMETRO ASTA / ROD DIAMETER	TERMINALE/FINIAL	
	A mm	B mm
Diametro mm	A mm	B mm
Ø 20	54	27
Ø 16	45	20
Ø 14	40	16
Ø 12	35	14

## IA136 SILVY



DIAMETRO ASTA / ROD DIAMETER	TERMINALE/FINIAL	
	A mm	B mm
Diametro mm	A mm	B mm
Ø 20	56	32
Ø 16	46	26
Ø 14	40	21
Ø 12	35	20

## IA131 SELEN



DIAMETRO ASTA / ROD DIAMETER	TERMINALE/FINIAL	
	A mm	B mm
Diametro mm	A mm	B mm
Ø 20	58	32
Ø 16	46	26
Ø 14	39	22
Ø 12	35	20

## IA133 SHARON



DIAMETRO ASTA / ROD DIAMETER	TERMINALE/FINIAL	
	A mm	B mm
Diametro mm	A mm	B mm
Ø 20	53	31
Ø 16	43	26
Ø 14	37	20
Ø 12	32	19

## IA132 SABRY



DIAMETRO ASTA / ROD DIAMETER	TERMINALE/FINIAL	
	A mm	B mm
Diametro mm	A mm	B mm
Ø 20	56	31
Ø 16	46	25
Ø 14	40	22
Ø 12	35	20

## IA134 SUSAN

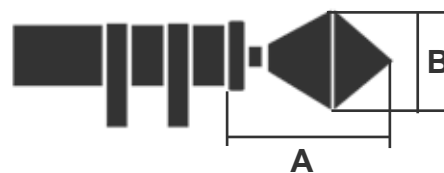

DIAMETRO ASTA / ROD DIAMETER	TERMINALE/FINIAL	
	A mm	B mm
Diametro mm	A mm	B mm
Ø 20	56	31
Ø 16	45	26
Ø 14	39	22
Ø 12	34	20

IA138 SHILA



DIAMETRO ASTA / ROD DIAMETER	TERMINALE/FINIAL	
	A mm	B mm
Diametro mm	A mm	B mm
Ø 20	43	31
Ø 16	37	26
Ø 14	29	22
Ø 12	27	18

IA135 SIRIA

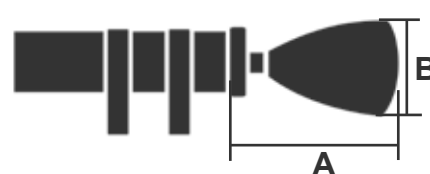

DIAMETRO ASTA / ROD DIAMETER	TERMINALE/FINIAL	
	A mm	B mm
Diametro mm	A mm	B mm
Ø 20	57	32
Ø 16	46	26
Ø 14	39	22
Ø 12	35	20

IA137 SAHRA



DIAMETRO ASTA / ROD DIAMETER	TERMINALE/FINIAL	
	A mm	B mm
Diametro mm	A mm	B mm
Ø 20	55	27
Ø 16	46	22
Ø 14	39	18
Ø 12	35	16

IA139 SIMON



DIAMETRO ASTA / ROD DIAMETER	TERMINALE/FINIAL	
	A mm	B mm
Diametro mm	A mm	B mm
Ø 20	24	5
Ø 16	20	5
Ø 14	16	5
Ø 12	14	5

Linea Sky \_\_\_\_\_ FERMATENDA / TIE BACK \_\_\_\_\_

IS139 SUN SIMON

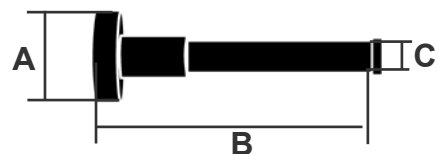

A mm	B mm	C mm
35	50-120	14

A mm	B mm	C mm
35	50-250	14

IM139 MOON SIMON

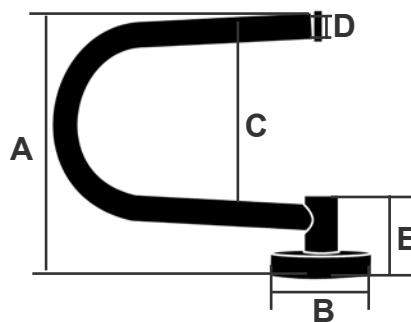

A mm	B mm	C mm	E mm	D mm
94	35	65	55	12

PER I FERMATENDA MOON E SUN VENGONO UTILIZZATI I FINALI SKY DA D.12  
TIE BACK MOON AND SUN ARE MADE WITH SKY FINIALS D.12

IA330 DIONE

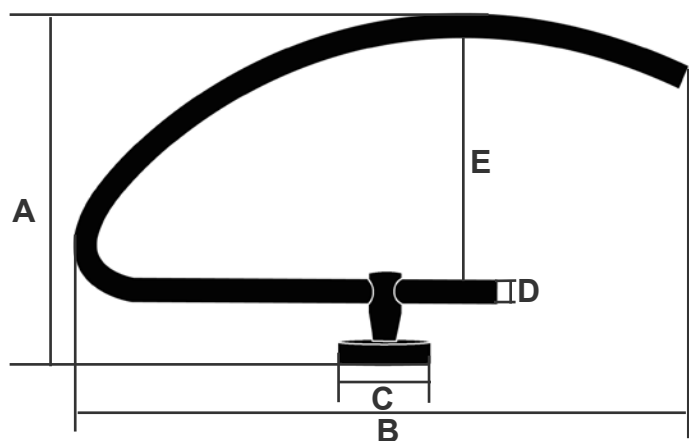

A mm	B mm	C mm	D mm	E mm
220	350	35	12	160

IA331 DEIMOS

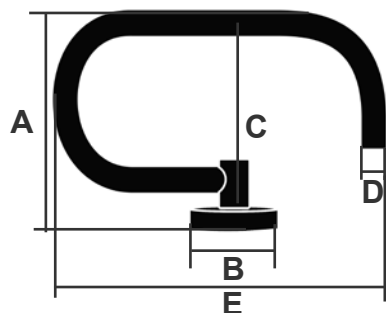

A mm	B mm	C mm	D mm	E mm
112	35	68	12	180

# Linea Brillanti ————— FERMATENDA / TIE BACK

## FERMATENDA MOON TIE BACK MOON

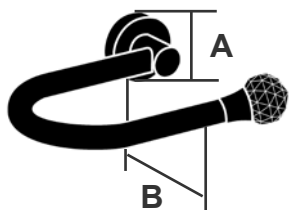

DIAMETRO TUBETTO / TUBE DIAMETER	TERMINALE/FINIAL	
Diametro mm	A mm	B mm
Ø 12	35	94

FERMATENDA MOON E SUN CON TERM. BRILLANTI D.12 OPPURE CON TERM. CLASSIC, MODERN, SMALL  
TIE BACK MOON AND SUN WITH FINIAL BRILLANTI D.12 OR WITH CLASSIC, MODERN, SMALL FINIALS

# Linea Sky e Brillanti ————— SUPPORTI / BRACKETS

## IA250 SKY CHIUSO SKY CLOSED

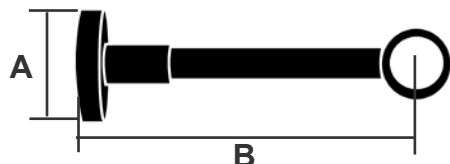

DIAMETRO ASTA ROD DIAMETER	A mm	B mm
Ø 20	45	50-160
Ø 16	45	
Ø 14	35	
Ø 12	35	

DIAMETRO ASTA ROD DIAMETER	A mm	B mm
Ø 20	45	50-250
Ø 16	45	
Ø 14	35	
Ø 12	35	

## IA252 SKY CHIUSO DOPPIO SKY DOUBLE CLOSED

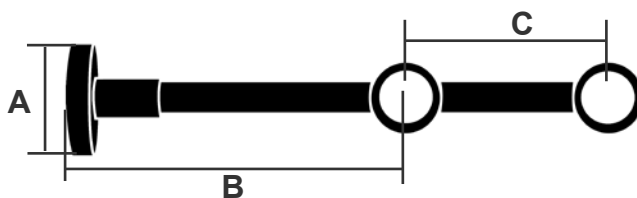

DIAMETRO ASTA ROD DIAMETER	A mm	B mm	C mm
Ø 20	45	50-160	70
Ø 16	45		66
Ø 14	35		64
Ø 12	35		62

DIAMETRO ASTA ROD DIAMETER	A mm	B mm	C mm
Ø 20	45	50-250	70
Ø 16	45		66
Ø 14	35		64
Ø 12	35		62

## IA255 SKY APERTO SKY OPENED

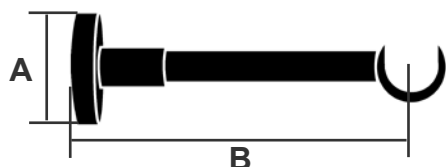

DIAMETRO ASTA ROD DIAMETER	A mm	B mm
Ø 20	45	50-160

DIAMETRO ASTA ROD DIAMETER	A mm	B mm
Ø 20	45	50-250

## IA257 SKY APERTO DOPPIO SKY DOUBLE OPENED

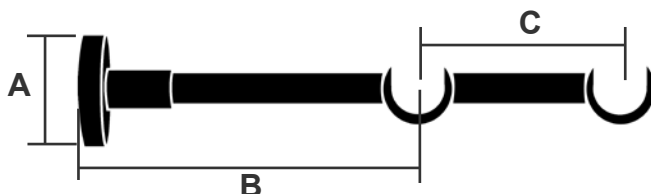

DIAMETRO ASTA ROD DIAMETER	A mm	B mm	C mm
Ø 20	45	50-160	70

DIAMETRO ASTA ROD DIAMETER	A mm	B mm	C mm
Ø 20	45	50-250	70

**IA260 SKY ANGOLARE  
SKY CORNER**

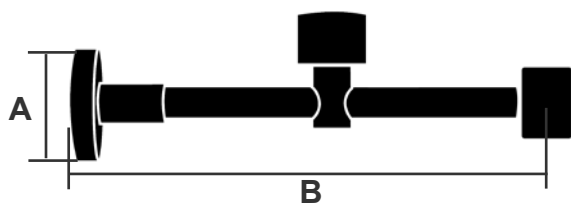

DIAMETRO ASTA ROD DIAMETER	A mm	B mm
Ø 20	45	50-160
Ø 16	45	
Ø 14	35	
Ø 12	35	

DIAMETRO ASTA ROD DIAMETER	A mm	B mm
Ø 20	45	50-250
Ø 16	45	
Ø 14	35	
Ø 12	35	

**IA265 MONOBLOCCO  
MONOBLOC**

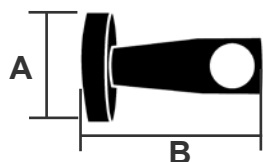

DIAMETRO ASTA ROD DIAMETER	A mm	B mm
Ø 20	45	67
Ø 16	45	55
Ø 14	35	49
Ø 12	35	42

**IA180 ATTACCO A SOFFITTO  
CEILING BRACKET**

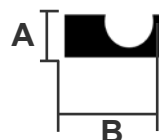

DIAMETRO ASTA ROD DIAMETER	A mm	B mm
Ø 20	24	38
Ø 16	24	34

IA195 MODERN

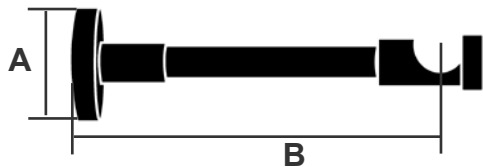

DIAMETRO ASTA ROD DIAMETER	A mm	B mm
Ø 20	45	50-160

DIAMETRO ASTA ROD DIAMETER	A mm	B mm
Ø 20	45	50-250

IA197 MODERN DOPPIO  
MODERN-DOUBLE

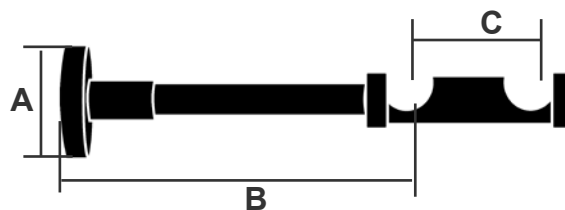

DIAMETRO ASTA ROD DIAMETER	A mm	B mm	C mm
Ø 20	45	50-160	40

DIAMETRO ASTA ROD DIAMETER	A mm	B mm	C mm
Ø 20	45	50-250	40

IA221 TECNO

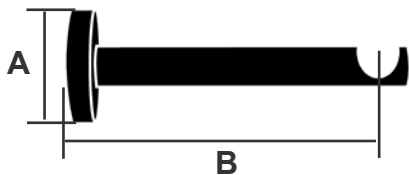

DIAMETRO ASTA ROD DIAMETER	A mm	B mm
Ø 20	45	55
Ø 16	45	
Ø 14	35	
Ø 12	35	

DIAMETRO ASTA ROD DIAMETER	A mm	B mm
Ø 20	45	120
Ø 16	45	
Ø 14	35	
Ø 12	35	

DIAMETRO ASTA ROD DIAMETER	A mm	B mm
Ø 20	45	160
Ø 16	45	
Ø 14	35	
Ø 12	35	

DIAMETRO ASTA ROD DIAMETER	A mm	B mm
Ø 20	45	210
Ø 16	45	
Ø 14	35	
Ø 12	35	

IA223 TECNO DOPPIO  
DOUBLE TECNO

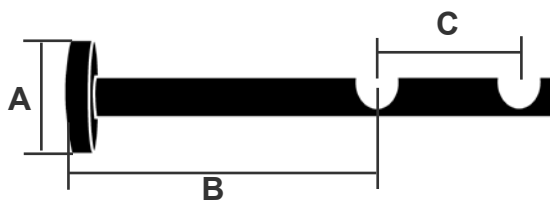

DIAMETRO ASTA ROD DIAMETER	A mm	B mm	C mm
Ø 20	45	120	50
Ø 16	45		
Ø 14	35		
Ø 12	35		

DIAMETRO ASTA ROD DIAMETER	A mm	B mm	C mm
Ø 20	45	160	50
Ø 16	45		
Ø 14	35		
Ø 12	35		

DIAMETRO ASTA ROD DIAMETER	A mm	B mm	C mm
Ø 20	45	210	50
Ø 16	45		
Ø 14	35		
Ø 12	35		



**IA266 SKY SOFFITTO  
SKY-CEILING**

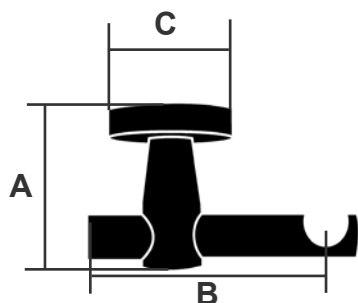

DIAMETRO ASTA ROD DIAMETER	A mm	B mm	C mm
Ø 20	67	60	45
Ø 16	67	60	45

**IA267 SKY SOFFITTO DOPPIO  
SKY-CEILING DOUBLE**

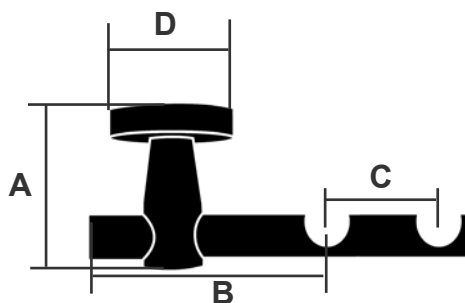

DIAMETRO ASTA ROD DIAMETER	A mm	B mm	C mm	D mm
Ø 20	67	60	50	45
Ø 16	67	60	50	45

**IA270 ROSETTA CHIUSA  
CLOSED RECESS BRACKET**

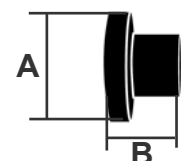

DIAMETRO ASTA ROD DIAMETER	A mm	B mm
Ø 20	35	24
Ø 16	27	18
Ø 14	24	15
Ø 12	20	13

**IA271 ROSETTA APERTA  
OPEN RECESS BRACKET**

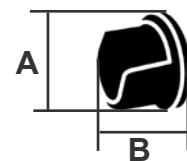

DIAMETRO ASTA ROD DIAMETER	A mm	B mm
Ø 20	35	24
Ø 16	27	18

————— ANELLI / RINGS ———

**IA230-IA231 ANELLO SEZIONE TONDA  
ROUND RING**

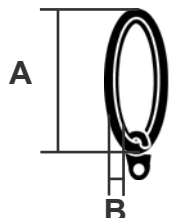

DIAMETRO ASTA ROD DIAMETER	A mm	B mm
Ø 20	48	4
Ø 16	38	4

**IA232-IA233 ANELLO SEZIONE PIATTA  
FLAT RING**

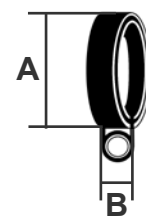

DIAMETRO ASTA ROD DIAMETER	A mm	B mm
Ø 20	40	6
Ø 16	35	5
Ø 14	27	5
Ø 12	27	5