

frandoli

Schede Tecniche

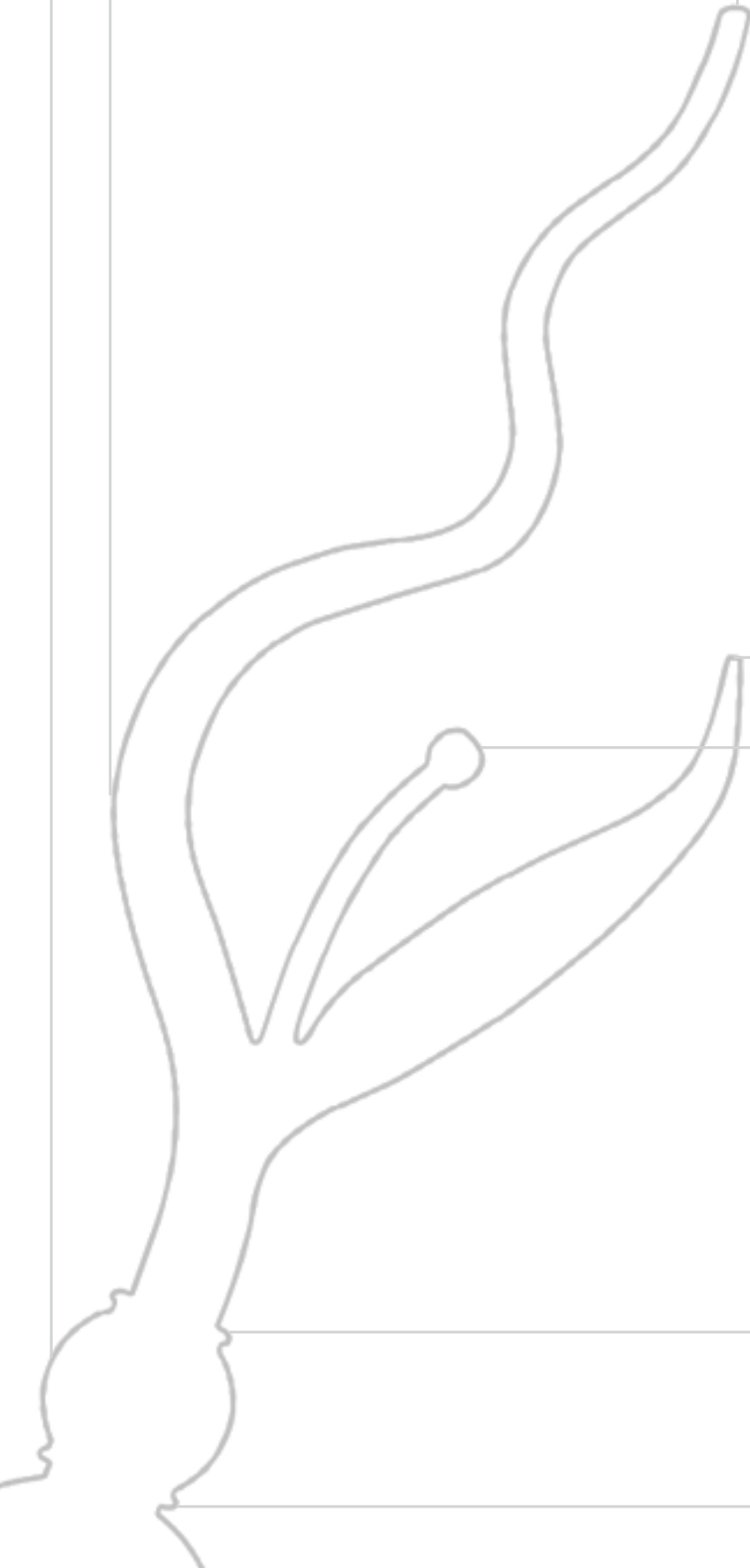

# Linea Sky ————— TERMINALI / FINIALS —————

## IA130 SOPHY



DIAMETRO ASTA / ROD DIAMETER	TERMINALE/FINIAL	
	A mm	B mm
Diametro mm	A mm	B mm
Ø 20	54	27
Ø 16	45	20
Ø 14	40	16
Ø 12	35	14

## IA136 SILVY



DIAMETRO ASTA / ROD DIAMETER	TERMINALE/FINIAL	
	A mm	B mm
Diametro mm	A mm	B mm
Ø 20	56	32
Ø 16	46	26
Ø 14	40	21
Ø 12	35	20

## IA131 SELEN



DIAMETRO ASTA / ROD DIAMETER	TERMINALE/FINIAL	
	A mm	B mm
Diametro mm	A mm	B mm
Ø 20	58	32
Ø 16	46	26
Ø 14	39	22
Ø 12	35	20

## IA133 SHARON



DIAMETRO ASTA / ROD DIAMETER	TERMINALE/FINIAL	
	A mm	B mm
Diametro mm	A mm	B mm
Ø 20	53	31
Ø 16	43	26
Ø 14	37	20
Ø 12	32	19

## IA132 SABRY



DIAMETRO ASTA / ROD DIAMETER	TERMINALE/FINIAL	
	A mm	B mm
Diametro mm	A mm	B mm
Ø 20	56	31
Ø 16	46	25
Ø 14	40	22
Ø 12	35	20

## IA134 SUSAN

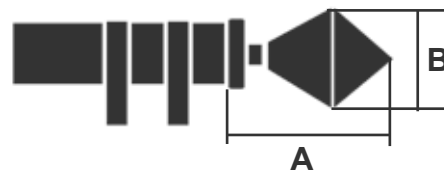

DIAMETRO ASTA / ROD DIAMETER	TERMINALE/FINIAL	
	A mm	B mm
Diametro mm	A mm	B mm
Ø 20	56	31
Ø 16	45	26
Ø 14	39	22
Ø 12	34	20

IA138 SHILA



DIAMETRO ASTA / ROD DIAMETER	TERMINALE/FINIAL	
	A mm	B mm
Diametro mm	A mm	B mm
Ø 20	43	31
Ø 16	37	26
Ø 14	29	22
Ø 12	27	18

IA135 SIRIA

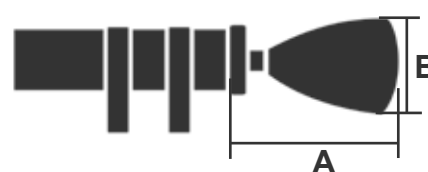

DIAMETRO ASTA / ROD DIAMETER	TERMINALE/FINIAL	
	A mm	B mm
Diametro mm	A mm	B mm
Ø 20	57	32
Ø 16	46	26
Ø 14	39	22
Ø 12	35	20

IA137 SAHRA



DIAMETRO ASTA / ROD DIAMETER	TERMINALE/FINIAL	
	A mm	B mm
Diametro mm	A mm	B mm
Ø 20	55	27
Ø 16	46	22
Ø 14	39	18
Ø 12	35	16

IA139 SIMON



DIAMETRO ASTA / ROD DIAMETER	TERMINALE/FINIAL	
	A mm	B mm
Diametro mm	A mm	B mm
Ø 20	24	5
Ø 16	20	5
Ø 14	16	5
Ø 12	14	5

Linea FAMILY \_\_\_\_\_ TERMINALI / FINIALS

IA091 DENNY IA090 MARTY

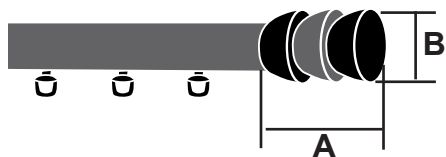

DIAMETRO ASTA / ROD DIAMETER	TERMINALE/FINIAL	
Diametro mm	A mm	B mm
Ø 20	45	30
Ø 16	36	24

IA095 RICKY IA094 LILLY

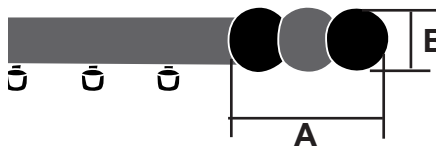

DIAMETRO ASTA / ROD DIAMETER	TERMINALE/FINIAL	
Diametro mm	A mm	B mm
Ø 20	63	26
Ø 16	53	21

IA099 PONGHY IA098 ELE

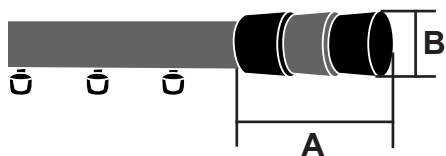

DIAMETRO ASTA / ROD DIAMETER	TERMINALE/FINIAL	
Diametro mm	A mm	B mm
Ø 20	60	27
Ø 16	36	22

IA093 DUKY IA092 LEO

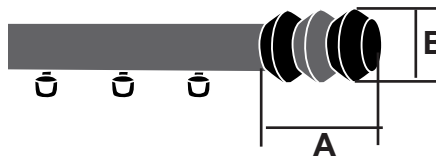

DIAMETRO ASTA / ROD DIAMETER	TERMINALE/FINIAL	
Diametro mm	A mm	B mm
Ø 20	45	30
Ø 16	36	24

IA097 DADO IA096 GOGHY

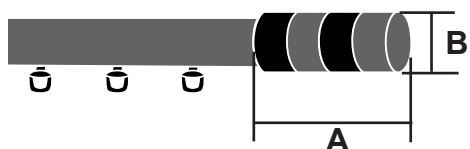

DIAMETRO ASTA / ROD DIAMETER	TERMINALE/FINIAL	
Diametro mm	A mm	B mm
Ø 20	60	25
Ø 16	48	20

IA299-IA298 SUPPORTO MARY-ARY  
MARY-ARY BRACKET

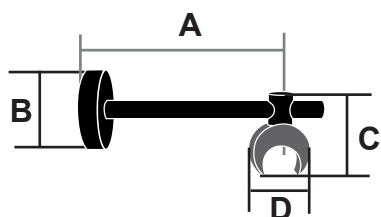

DIAMETRO DIAMETER	A mm	B mm	C mm	D mm
Ø 16	60	45	45	30
Ø 20	60	45	47	32

DIAMETRO DIAMETER	A mm	B mm	C mm	D mm
Ø 16	120	45	45	30
Ø 20	120	45	47	32

DIAMETRO DIAMETER	A mm	B mm	C mm	D mm
Ø 16	180	45	45	30
Ø 20	180	45	47	32

DIAMETRO DIAMETER	A mm	B mm	C mm	D mm
Ø 16	210	45	45	30
Ø 20	210	45	47	32

IA295-IA297 BOCCOLA SOFFITTO MARY-ARY  
MARY-ARY CEILING BRACKET

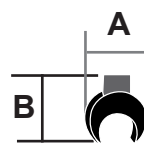

DIAMETRO DIAMETER	A mm	B mm
Ø 16	30	33
Ø 20	32	35

**IA250 SKY CHIUSO**  
**SKY CLOSED**

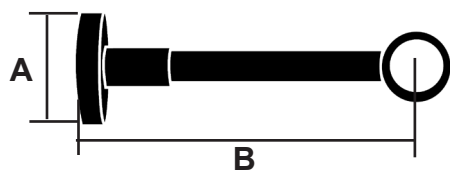

DIAMETRO ASTA ROD DIAMETER	A mm	B mm
Ø 20	45	50-160
Ø 16	45	

DIAMETRO ASTA ROD DIAMETER	A mm	B mm
Ø 20	45	50-250
Ø 16	45	

**IA252 SKY CHIUSO DOPPIO**  
**SKY DOUBLE CLOSED**

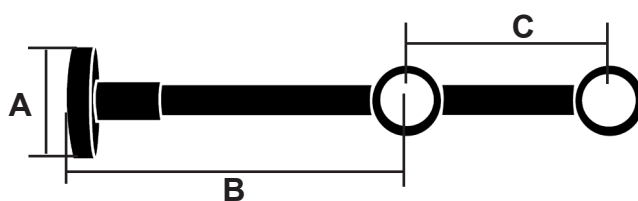

DIAMETRO ASTA ROD DIAMETER	A mm	B mm	C mm
Ø 20	45	50-160	70
Ø 16	45		66

DIAMETRO ASTA ROD DIAMETER	A mm	B mm	C mm
Ø 20	45	50-250	70
Ø 16	45		66

**IA255 SKY APERTO**  
**SKY OPENED**

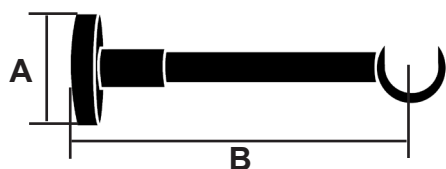

DIAMETRO ASTA ROD DIAMETER	A mm	B mm
Ø 20	45	50-160

DIAMETRO ASTA ROD DIAMETER	A mm	B mm
Ø 20	45	50-250

**IA257 SKY APERTO DOPPIO**  
**SKY DOUBLE OPENED**

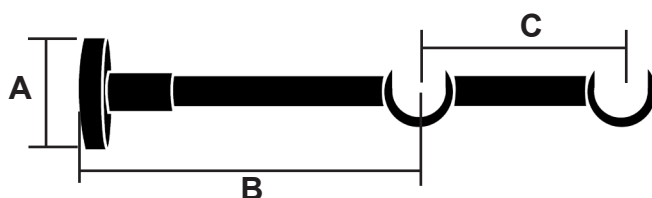

DIAMETRO ASTA ROD DIAMETER	A mm	B mm	C mm
Ø 20	45	50-160	70

DIAMETRO ASTA ROD DIAMETER	A mm	B mm	C mm
Ø 20	45	50-250	70

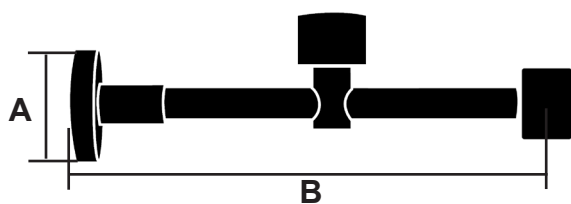
IA260 SKY ANGOLARE  
SKY CORNER

DIAMETRO ASTA ROD DIAMETER	A mm	B mm
Ø 20	45	50-160
Ø 16	45	

DIAMETRO ASTA ROD DIAMETER	A mm	B mm
Ø 20	45	50-250
Ø 16	45	

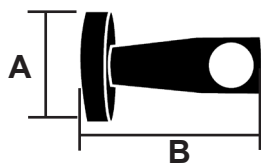
IA265 MONOBLOCCO  
MONOBLOC

DIAMETRO ASTA ROD DIAMETER	A mm	B mm
Ø 20	45	67
Ø 16	45	55

IA180 ATTACCO A SOFFITTO  
CEILING BRACKET

DIAMETRO ASTA ROD DIAMETER	A mm	B mm
Ø 20	24	38
Ø 16	24	34

**IA266 SKY SOFFITTO  
SKY-CEILING**

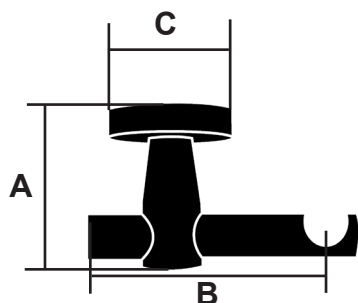

DIAMETRO ASTA ROD DIAMETER	A mm	B mm	C mm
Ø 20	55	120	45
Ø 16	55	120	45

**IA267 SKY SOFFITTO DOPPIO  
SKY-CEILING DOUBLE**

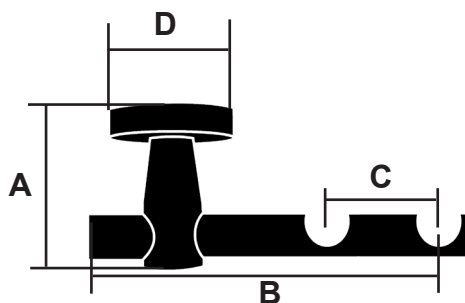

DIAMETRO ASTA ROD DIAMETER	A mm	B mm	C mm	D mm
Ø 20	55	120	50	45
Ø 16	55	120	50	45

**IA221 TECNO  
TECNO BRACKET**

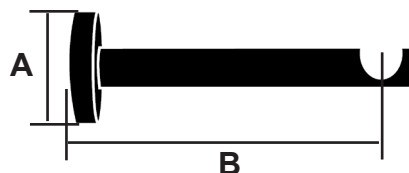

DIAMETRO ASTA ROD DIAMETER	A mm	B mm
Ø 20	45	55
Ø 16	45	

DIAMETRO ASTA ROD DIAMETER	A mm	B mm
Ø 20	45	120
Ø 16	45	

DIAMETRO ASTA ROD DIAMETER	A mm	B mm
Ø 20	45	160
Ø 16	45	

DIAMETRO ASTA ROD DIAMETER	A mm	B mm
Ø 20	45	210
Ø 16	45	

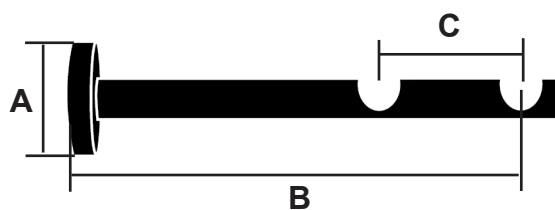

**IA223 TECNO DOPPIO  
DOUBLE TECNO**

DIAMETRO ASTA ROD DIAMETER	A mm	B mm	C mm
Ø 20	45	120	50
Ø 16	45		

DIAMETRO ASTA ROD DIAMETER	A mm	B mm	C mm
Ø 20	45	160	50
Ø 16	45		

DIAMETRO ASTA ROD DIAMETER	A mm	B mm	C mm
Ø 20	45	210	50
Ø 16	45		

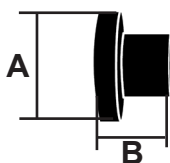
**IA270 ROSETTA CHIUSA  
CLOSED RECESS BRACKET**

DIAMETRO ASTA ROD DIAMETER	A mm	B mm
Ø 20	35	24
Ø 16	27	18

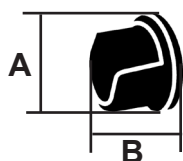
**IA271 ROSETTA APERTA  
OPEN RECESS BRACKET**

DIAMETRO ASTA ROD DIAMETER	A mm	B mm
Ø 20	35	24
Ø 16	27	18

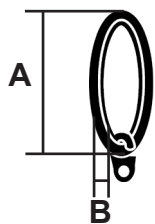
IA230-IA231 ANELLO SEZIONE TONDA  
ROUND RING

DIAMETRO ASTA ROD DIAMETER	A mm	B mm
Ø 20	48	4
Ø 16	38	4

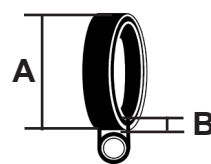
IA232-IA233 ANELLO SEZIONE PIATTA  
FLAT RING

DIAMETRO ASTA ROD DIAMETER	A mm	B mm
Ø 20	40	2
Ø 16	35	2

## FERMATENDA / CURTAIN STOP

## IS091 SUN DENNY

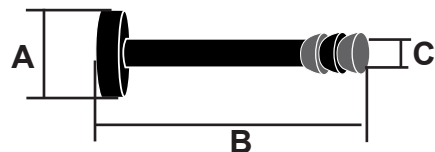

A mm	B mm	C mm
35	50-120	14
A mm	B mm	C mm
35	50-250	14

## IM091 MOON DENNY

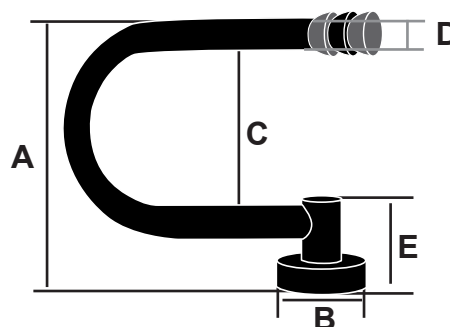

A mm	B mm	C mm	E mm	D mm
94	35	65	55	12

PER I FERMATENDA MOON E SUN VENGONO UTILIZZATI I FINALI FAMILY DA D.12  
CURTAIN STOP MOON AND SUN ARE MADE WITH FAMILY FINIALS D.12

## IA182 FIOCCO

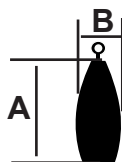

DIAMETRO ASTA ROD DIAMETER	A mm	B mm
Ø 18	43	20